

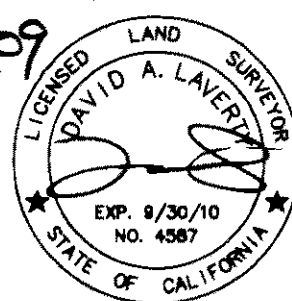

SHEET 1 OF 1

BEING A SURVEY OF LOTS 8 & 9 OF BLOCK 28, SILVER LAKE PINES TRACT NO. 5,
RECORDED IN MAP BOOK 1 AT PAGE 11 OF OFFICIAL RECORDS ON FILE IN THE OFFICE
OF THE COUNTY RECORDER. LOCATED IN THE NW 1/4 OF SECTION 21, T2S, R26E,
M.D.B.&M.

DAVID LAVERTY *Wood 252*
L.S. 4587 DATE
LIC. EXP. 9-30-10



MONO COUNTY SURVEYOR

JOHN S. PARRISH
LIC. NO. 5050



INSTRUMENT NO. : 2009001568
FEE : \$ 8.00

FILED THIS 8th DAY OF APRIL 2009
AT 2:11 P.M. IN BOOK 4 OF RECORD OF
SURVEY MAPS AT PAGE 66 AT THE REQUEST
OF HOWARD & RACHEL SNOWDEN

LYNDA ROBERTS
MONO COUNTY RECORDER

BY: Sherril R. Hale
DEPUTY COUNTY RECORDER

THE REASON FOR THIS RECORD OF SURVEY IS AS SET FORTH IN THE PROFESSIONAL LAND SURVEYOR'S ACT, ARTICLE 5, 8762(b)(2): A MATERIAL DISCREPANCY WITH THE INFORMATION CONTAINED IN ANY SUBDIVISION MAP, OFFICIAL MAP, OR RECORD OF SURVEY PREVIOUSLY RECORDED OR FILED IN THE OFFICE OF THE COUNTY RECORDER OR THE COUNTY SURVEYING DEPARTMENT, OR ANY MAP OR SURVEYED RECORD MAINTAINED BY THE BUREAU OF LAND MANAGEMENT OF THE UNITED STATES. FOR THE PURPOSES OF THIS SUBDIVISION, A "MATERIAL DISCREPANCY" IS LIMITED TO A MATERIAL DISCREPANCY IN THE POSITION OF POINTS OR LINES, OR IN DIMENSIONS.

- FOUND MONUMENT AS NOTED
- SET 5/8" REBAR W/CAP "LS 4587"

(R) RECORD INFORMATION

(M) MEASURED

(C) CALCULATED

FND FOUND

RBC REBAR WITH CAP

IP IRON PIPE

L&T LEAD & TAG

MB MAP BOOK

PMB PARCEL MAP BOOK

THE BASIS OF BEARINGS IS THE WEST LINE OF NEVADA STREET INCLUDING THE DEDICATION FOR RIGHT OF WAY BETWEEN TWO FOUND MONUMENTS PER PMB 4/52A AND IS SHOWN HEREON AS N 46°33'57" W.

(R1) = RECORD INFORMATION PER
MAP BOOK 1, PAGE 11

(R2) = RECORD INFORMATION PER PARCEL
MAP BOOK 2, PAGE 38

(R3) = RECORD INFORMATION PER PARCEL
MAP BOOK 4, PAGE 52A

(R4) = RECORD INFORMATION PER RECORD
OF SURVEY MAP BOOK 3, PAGE 84

